

Scale: 1:100 (1:100 sections)

Changing House Plan

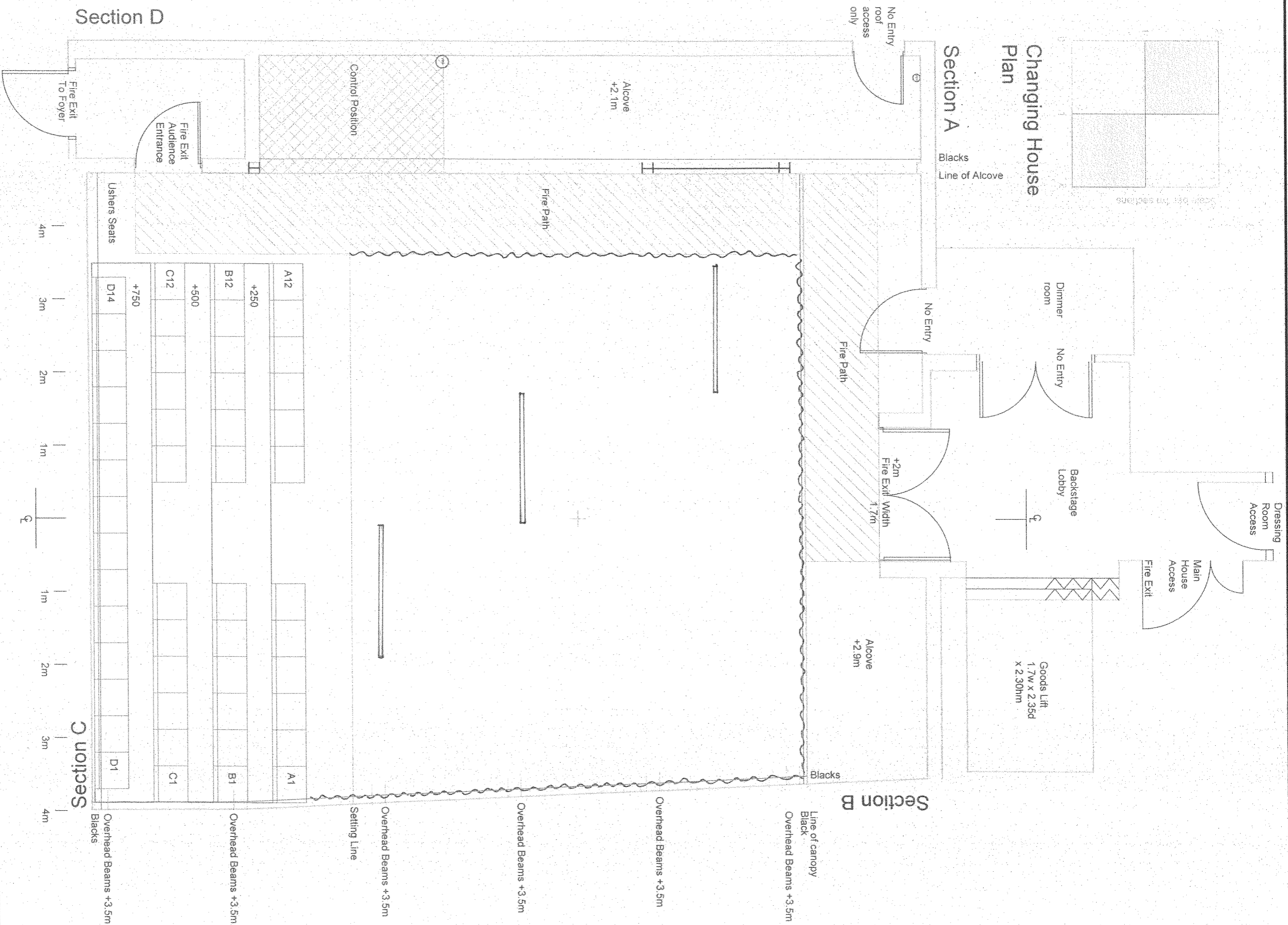

- Hessian

VENUE INFORMATION

Setting Line - 1.1m in front of Stairs
 Stage Area - 7.4m wide x 6.3m deep
 Seating - Seating Capacity - 50
 End on seating with a 3 tiered seating bank with 1 row on the floor
 Control Position is to the SR of stage area

Notes
 REQUIRED DIMENSION TO BE TAKEN IN PREFERENCE TO SCALED DIMENSIONS
 ALL DIMENSIONS TO BE CHECKED ON SITE

Tron Theatre Ltd, 63 Tongnate, Glasgow, G1 5HB
 Box Office: 0141 552 4287
 Bar Kitchen: 0141 502 8987
 Tron Theatre Ltd is a Scottish registered charity, No: SC012081
 Glasgow City Council
 Scottish Arts Council
 Scottish Arts Council Lottery Funded

PRODUCTION TITLE
*** THE POSSIBILITIES**
 DRAWING TITLE
 Changing House - Ground Plan

SCALE	A3 @ 1:50
DIRECTOR	* GUY HOLLANDS
DATE	MARCH '13
VENUE	Tron Theatre
SET DESIGNER	* CASSIE PETTIGREW
LIGHTING DESIGNER	* OLIVER GORMAN
DRAWING NUMBER	1 of 4