

Changing House Plan

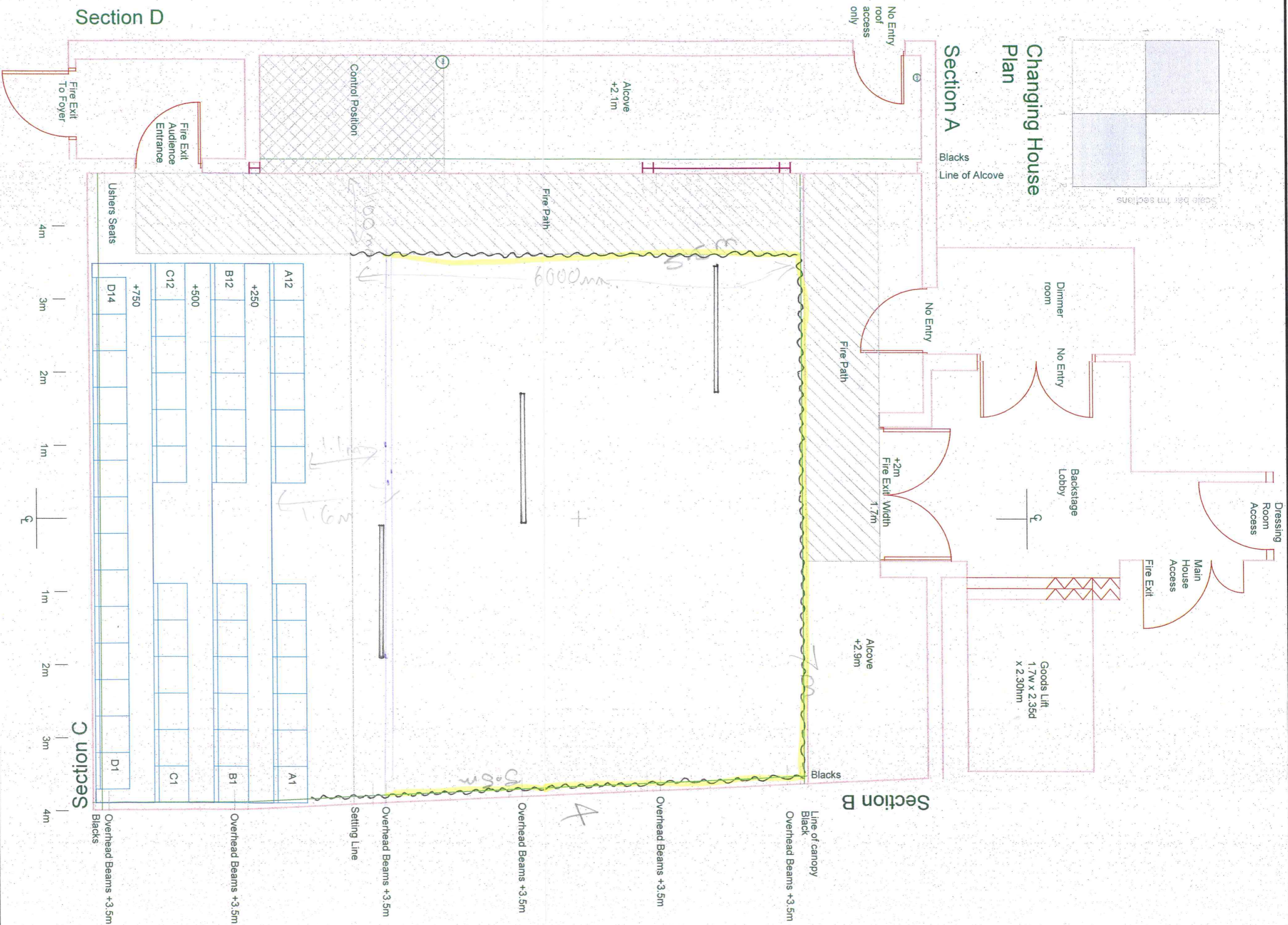

VENUE INFORMATION

Setting Line - 1.1m in front of *Stairs Seats*
 Stage Area - 7.4m wide x 6.3m deep
 Seating - Seating Capacity - 50
 End on seating with a 3 tiered seating bank with 1 row on the floor
 Control Position is to the SR of stage area

Hessian

ALL DIMENSIONS TO BE CHECKED ON SITE

Tron Theatre Ltd, 63 Troongate, Glasgow, G1 5HB
 Box Office: 0141 552 4287
 Bar Kitchen: 0141 552 8587
 Tron Theatre Ltd is a Scottish registered charity, No: SC012081
 Glasgow City Council
 Scottish Arts Council
 Scottish Arts Council Lottery Funded

PRODUCTION TITLE * THE POSSIBILITIES	
DRAWING TITLE Changing House - Ground Plan	
SCALE A3 @ 1:50	SET DESIGNER * CASSIE PETTIGREW
DIRECTOR * GUY HOLLANDS	LIGHTING DESIGNER * OLIVER GORMAN
DATE MARCH '13	DRAWING NUMBER 1 of 4
VENUE Tron Theatre Changing House - Ground Plan	